

TECHNICAL DATASHEET

ELECTRONIC CHAINSAW WITH CORDLESS LITHIUM

BATTERY 21,6V 4,0Ah

"KVS8000P"

1/4" chain and
8" bar

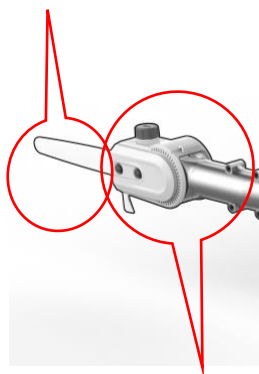

Steerable head with
integrated oil tank and line
for better level reading.
Automatic and adjustable
chain lubrication.

Display with indication
of battery charge and
working hours

Quick-
connection
rechargeable
lithium battery
21,6V 4,0Ah



Telescopic pole
Length (closed) = 170 cm
Length (open) = 250 cm

Double safety
switch

Ergonomic handle with
hand protection.

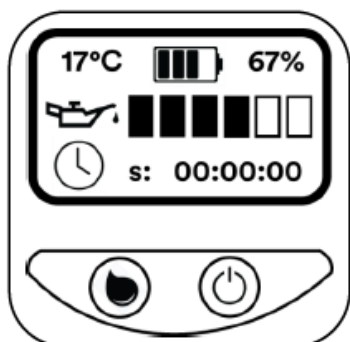
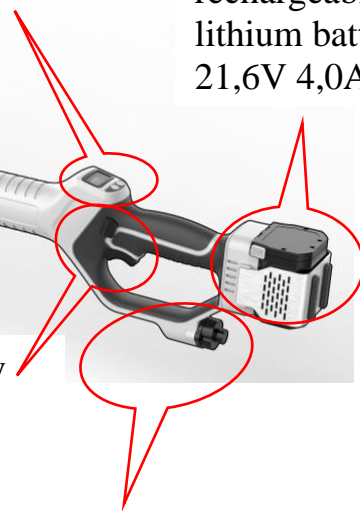

Display information:

- Electronic board temperature
- Battery charge level
- Lubrication settings
- Total and partial working time

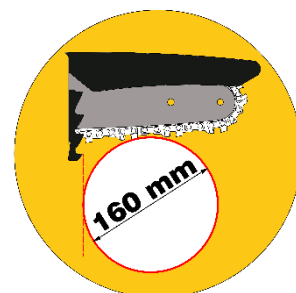



Davide e Luigi Volpi S.p.A.
Via San Rocco, 10
46040 CASALROMANO MN –ITALIA

COMPANY WITH QUALITY SYSTEM
MANAGEMENT CERTIFIED BY ICIM
= ISO 9001 =

STANDARD EQUIPMENT

Electronic chainsaw with cordless lithium battery
Two batteries 21,6V 4,0Ah
3-way battery charger
Service Kit
Bar cover

ELECTRONIC CHAINSAW WITH CORDLESS LITHIUM BATTERY 21,6 V 4,0 Ah

MAX CUTTING Ø	160 mm
BAR LENGHT	19,0 cm - 8"
CHAIN	1/4" X 1.1 48 links
CHAIN TENSION ADJUSTMENT	MANUAL
BAR LUBRICATION	AUTOMATIC AND ADJUSTABLE
GEARBOX LUBRICATION	MANUAL
DISPLAY INFORMATION	BATTERY CHARGE WORKING HOURS LUBRICATION PERCENTAGE
MOTOR	BRUSHLESS
POWER	950 W
NOMINAL TENSION	DC 21,6V
CHAINSAW DIMENSIONS	170/250 x 13 x 10 cm
WEIGHT (WITHOUT BATTERY)	4,0 Kg
WEIGHT (WITH BATTERY)	4,5 kg

LITHIUM BATTERY 21,6 V 4,0 Ah

TENSION	21,6 V
CAPACITY	4,0 Ah
POWER	86,4 Wh
WEIGHT	0,5 Kg
BATTERY CHARGER NOMINAL TENSION	100-240 V AC 50-60 Hz
RECHARGING TIME	4 HOURS

IMPORTANT: CAREFULLY FOLLOW THE INSTRUCTIONS TO THE USE OF THE PRODUCTS, GIVEN IN THE USER MANUALS.